

# CP/MST

## Core Platform/Multiport Service Terminal

Atlantic Vision's CP/MST advanced design reduced form terminal

Compatibility with OptiTap - used in almost every large scale FTTH deployment

Input port options: Flat Drop Cables, MPO trunks, and PLC Splitters

Industry best lead time and lower cost

### CP/MST 2 | 4 | 6 | 8 | 12 PORT

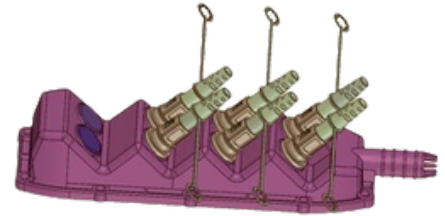
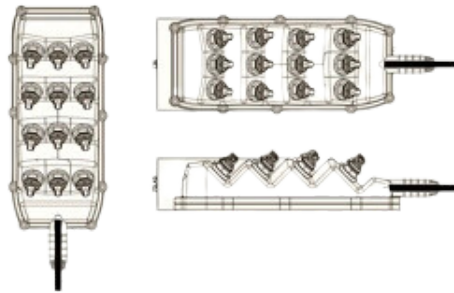

### Dimensions

Height 2/4 Port 71mm, 6/8 Port 69mm, 12 Port 73mms

Width 2/4 Port 105mm, 6/8 Port 105mm, 12 Port 140mm

Length 2/4 Port 255mm, 6/8 Port 349mm, 12 Port 317mm

IP68 Factory sealed with Plug and Play adapter ports

Cable type: Flat Drop Dielectric, Toneable, Round Port - Hardened full size SCA

Fiber type G.657.A1/A2, G.652D

Operating wavelength 1260-1635

Attenuation terminal connectors maximum 0.4dB

SCA IL  $\leq 20$ dB RL  $\geq 65$ dB

MPO IL  $\leq 30$ dB RL  $\geq 50$ dB

Operating temperature -40 to 80C

Hardened plastic UV Resistant

Color Black

Stub Tail

Mounting: Wall Pole Aerial



# CP/ST

## Core Platform/SuperTap Connector

Atlantic Vision's SuperTap - Hardened small form connector

Compatibility with OptiTap - Used in almost every large scale FTTH deployment

SCA, LC/DX and MPO, Male & Female versions

Use with Flat Drop or Round OSP cables

Lanyard protective connector cap

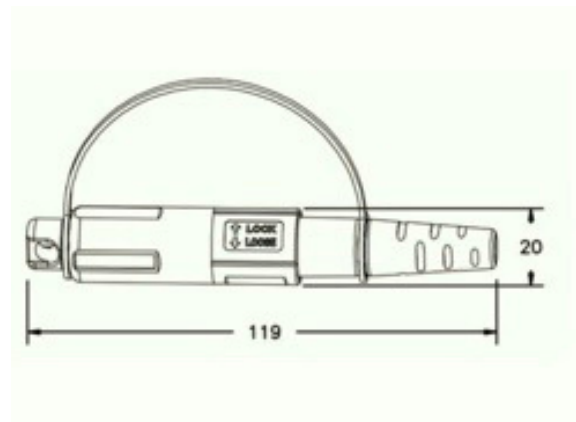
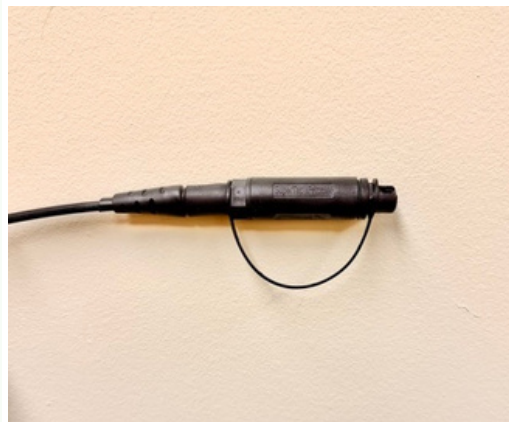
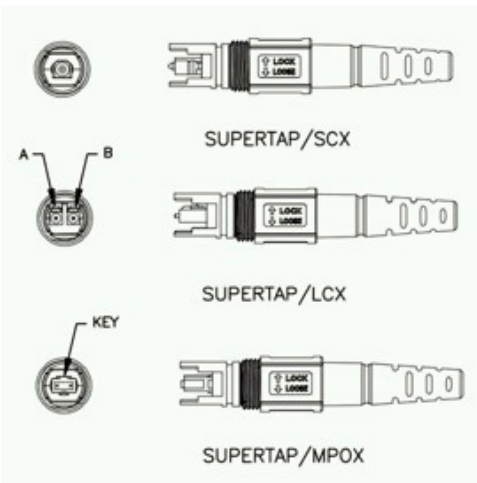

Hardened connector IP67 Protection Operating temperature -40 to 85C

SCA Performance  $IL \leq 0.15$   $RL \geq 65$ dB

MPO Performance  $IL \leq 0.30$   $RL \geq 50$ dB

Dimensions male 119mm x 20mm

Dimensions female 131mm x 20mm (photo)

Cable min bend radius 20D dynamic/10D static

RoHS Compliant



# CP/DC

## Core Platform/Drop Cables

Atlantic Vision's FTTH Drop Cables for aerial, duct, and direct burial

Compatible with SuperTap, OptiTap, and OptiTip connectors

Peelable jacket for easy stripping

Contractors familiar with cables and processes

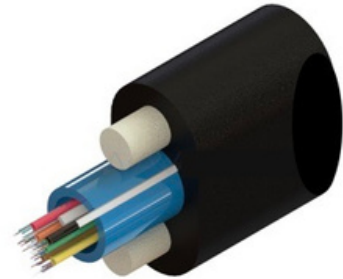
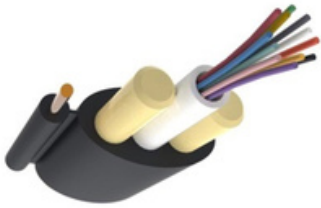

### Cable Types:

Flat Drop Dielectric/7mm Toneable/9.8mm

Round Dielectric/5mm Toneable/7.8mm

Fiber count 1-24

Fiber types G.657.A1/A2, G652.D

SC/APC typical IL  $\leq 0.15$ dB RL  $\geq 65$ dB

MPO Performance IL  $\leq 0.30$  RL  $\geq 50$ dB Attenuation 1310nm/0.36 1550nm/0.22

Jacket material PE Black

Loose tube fiber diameter 250um Tight buffer 900um/3mm PVC tube white

Strength member FRP

Operating temperature -40 to +70C

Telcordia GR 20 OSP

Cable tensile load Install 300lbs, long term 90lbs

