

NOVUX Compact Closures

A new-generation ecosystem simplifies FTTX deployments

CommScope’s new NOVUX™ ecosystem is the next step in the evolution of connectivity and fiber-to-the-X (FTTX) networks. Configurable, scalable and simple, NOVUX transforms networks with a modular, end-to-end architecture.

Modularity that outperforms

As fiber goes deeper into the network, how can FTTX providers in search of simple, responsive, and quickly configurable drop network components prepare for the technology changes to come? CommScope’s answer: the totally new NOVUX compact closures. Designed for FTTX drop applications, NOVUX compact closures are easily configurable and are available in high volumes to meet demand. And just as the right solution can be key to optimizing network performance, an experienced partner with l reach can help providers achieve their long-term goals of meeting the new demand for bandwidth and rollout speed. That partner is CommScope. We help companies around the world design, build, and manage their wired and wireless networks. The new NOVUX compact closures will help providers maximize today’s infrastructure while moving toward the future.

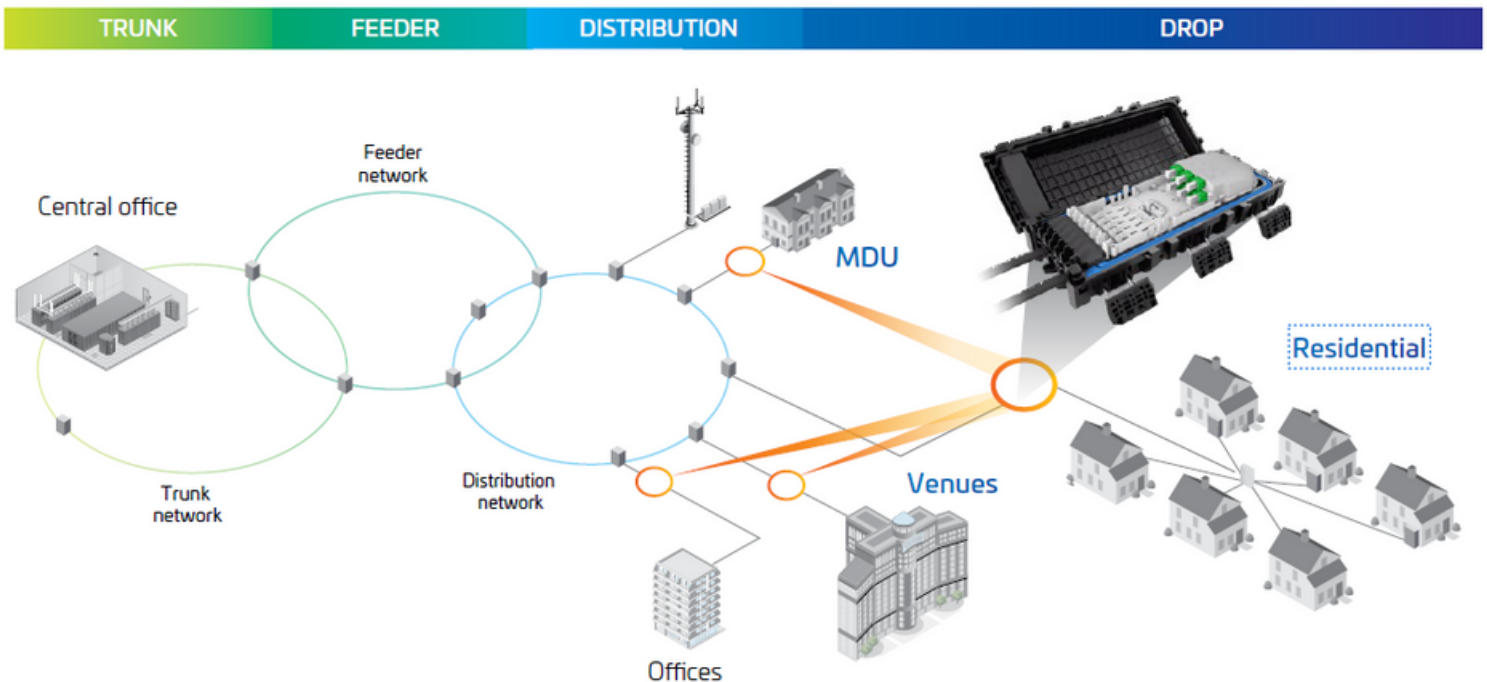

Application flexibility

—from the newest and most advanced CommScope technologies

CommScope’s new NOVUX™ ecosystem is the next step in the evolution of connectivity and fiber-to-the-X (FTTX) networks. Configurable, scalable and simple, NOVUX transforms networks with a modular, end-to-end architecture.

Designed for installers: easy installation, easy access

From the beginning, NOVUX compact closures were designed for ease of installation and access. And because we began with that goal in mind, your technicians will love the way this totally new component simplifies their fieldwork.

- Responds quickly to new field requirements, simplifying changes
- Advanced Octopus™ gel seal allows easy technician entry, even after numerous closure accesses
- Removable inner body with 360-degree access for ease of fiber routing
- Universal cable attachment with configure-to-order retention option

Octopus™ Gel Seal

Resilient and extremely conformable, Octopus gel protects delicate equipment from a wide range of harsh environmental conditions. This highly adaptable seal allows technicians entry for upgrades or maintenance, even after numerous closure accesses. In addition, a newly designated cable termination unit accommodates a wider range of cable sizes within the same closure. This design, in combination with the new Octopus gel, minimizes the need to measure cable size and match to the gel pack size. Providers can use nearly any cable materials and size.

Legacy meets Innovation Connectivity Independence

Splice only, pre-connectorized drop, or field-installable connector, so network planners can deploy the closure more easily in more locations with quick and easy access for new builds, expansions and upgrades.



Standard Connections



Spliced Connections

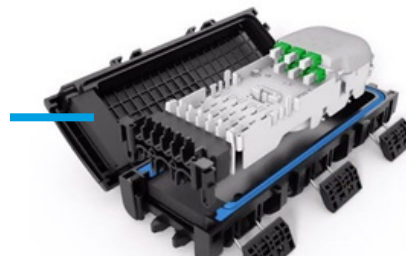

- 24 (splice/patch) or 48 (splice/splice)
- 6 SC or 12 LC, pre-connectorized or field-installed
- Up to 2 splitters with in-tray integration
- 6 or 12 drop
- Fiber identification

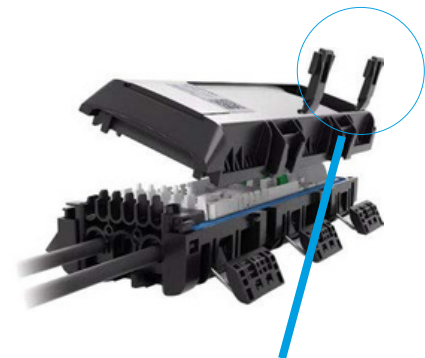

Removable hinge design

Innovative removable hinge design allows cover to open from the left, right or top

- Hinge lock system for security
- Black or gray colors
- IP68 2-meter water head

Ready for the field workforce of the future

Whatever your application and wherever you need to mount them, NOVUX compact closures are ready. Featuring built-in mounting clips and straps, they're easily and quickly mounted on nearly any surface. And to ease installation and maintenance, CommScope's mounting bracket can be used in all applications. This one common platform, backed by consistent documentation and training, ensures easy and efficient installations for all NOVUX compact closures.



Standard mounting clips



Pole mounting



Pedestal mounting



Strand mounting



Wall or flat surface mounting



Unique network identification

One-click access to all product information

NOVUX compact closures come with a QR code that allows installers to access CommScope's cTrak® app. With one click, cTrak provides a wealth of product information, specifications, installation instructions, videos, schematics, and test results.

NOVUX—built for you

You work hard to give your customers the best network connectivity. Why should your terminals look the same as those of other providers? NOVUX compact closures offer an optional customer-configurable ID plate.

- Ease of network record-keeping
- Clarity for multiple operators that share locations
- Helps installers find your closures and service your network faster

Investing in the planet

CommScope designed NOVUX using sustainable practices for packaging, labeling and installation, helping customers meet their own corporate sustainability goals.

All components come in compact, convenient packaging for optimal environmental benefit and minimize single-use plastic.

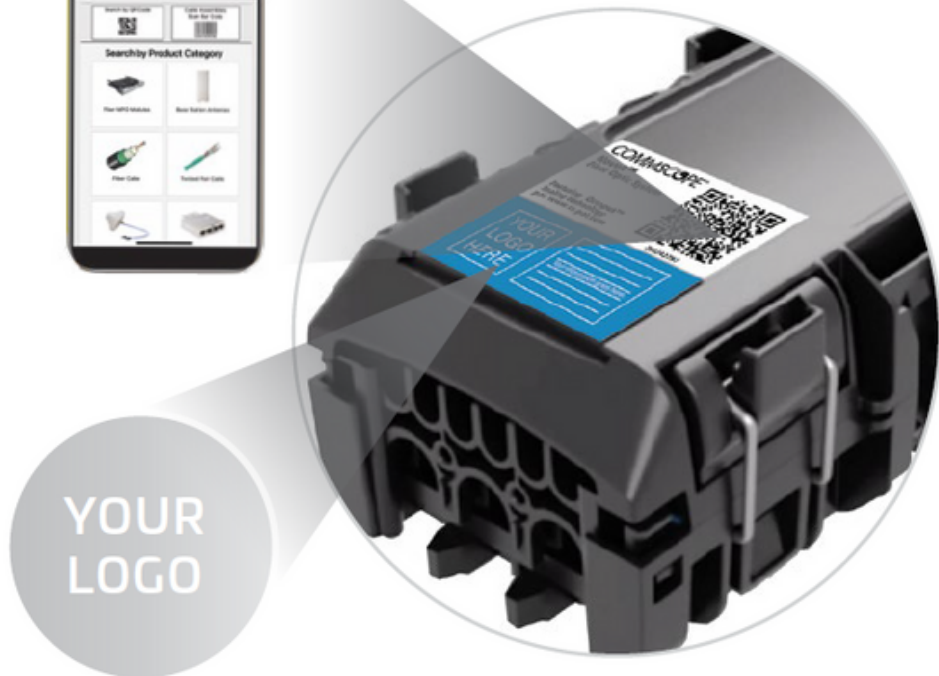
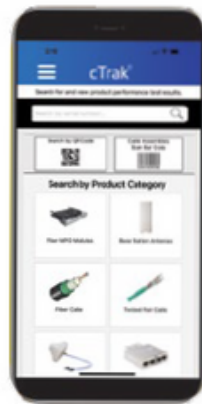

YOUR
LOGO



NOVUX compact closure CSC 100 ordering information

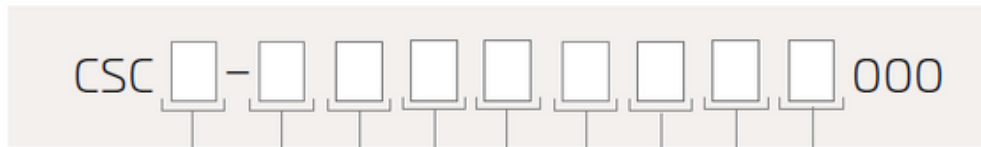

Size and color

3	6 Port black
4	6 Port gray

Sealing

U	Underground, IP68
---	-------------------

Connector type

1	SC/UPC
2	LC/UPC *
3	SC/APC
4	LC/APC *
5	Splice only

* With duplex adapters

Number of adapters

A	no adapters
C	4
D	6

Number of pigtails

1	None
3	4
4	6
6	12

Mounting

A	No mounting
B	Mounting clips
C	Mounting bracket

Splice Protector

B	Smouv 45
---	----------

Splitters

1	None
2	1:2
3	1:4
4	1:8
7	2 x 1:2
8	2 x 1:4

Pigtail colors

A	TIA 598
---	---------

Cable Termination Unit (CTU) options



NVX-CR-SA-SM-NN

- Round cable
- Small, up to 8 mm
- Strength member
- Aramide yarns
- Single layer



NVX-CR-TI-SM-NN

- Round cable
- Small, up to 8 mm
- Aramide yarns
- Single layer



NVX-CR-DU-SL-NN

- Round cable
- Dia up to 6.2 mm
- Aramide yarns
- Dual layer
- Compact length



NVX-CR-SA-SM-NN

- Round cable
- Small, up to 8 mm
- Strength member
- Aramide yarns
- Single layer



NVX-CR-TI-SM-NN

- Round cable
- Small, up to 8 mm
- Aramide yarns
- Single layer



NVX-CR-DU-SL-NN

- Round cable
- Dia up to 6.2 mm
- Aramide yarns
- Dual layer
- Compact length



NVX-CR-DU-FL-NN

- Round cable
- Dia up to 6.2 mm
- Aramide yarns
- Dual layer
- Full length