

INX 660 Probe Microscope

Automated single fiber connector inspection and analysis



Elevating Fiber Inspection: Faster, Simpler, Stronger, Smarter

While fiber inspection has become a standard practice for many field technicians, contamination still continues to be the #1 cause of optical network problems. With the increasing deployment of fiber optic connectors in the field and a growing number of technicians new to fiber, new inspection solutions are needed – the INX 660™ Probe Microscope.

With remarkable speed, simplicity and precision, the INX 660 brings the power of INX inspection to single fiber connectors.

Key Benefits

- **Faster:** results in seconds
- **Simpler:** true automated inspection of single fiber connectors
- **Stronger:** durability and dependability for field applications
- **Smarter:** inspection excellence with trusted results

Features

- True Automated Inspection automates every step of the inspection process to deliver the industry's fastest end-to-end workflow
- AutoID inspection tips eliminate manual setup and mistakes when changing tips
- VIAVI Test Process Automation (TPA) ensures alignment, efficiency and accuracy at every stage of the job

Applications

- Service providers
- MSOs
- FTTx installers



INX 660 Probe Microscope

Elevating Fiber Inspection



FASTER

Get results faster with true automated operation in seconds

With end-to-end inspection in under 5 seconds for a simplex connector, the INX 660 empowers field technicians to ensure clean fiber connectors in record time, every time.

Flawless Fiber Connections ... Fast



SIMPLER

Simplify fiber inspection with automated configuration, operation and job management.

AutoID technology auto-configures the microscope for the connector under inspection. The VIAVI TPA ecosystem connects project leads and field technicians to ensure repeatability, efficiency and accuracy at every stage of a job.

Effortless Inspection ... Single Fiber Connectors



STRONGER

Ensure performance in harsh environments with a microscope that delivers excellence in the field.

The INX 660 microscope is a field tool. The rugged stainless-steel tips thread securely onto the microscope. A textured, ergonomically shaped handle provides a secure grip, with and without gloves.

An energy absorbing overmold protects the microscope from damage due to handling in demanding field conditions.

Performance You Can Depend On ... Everywhere



SMARTER

Achieve inspection excellence with trusted results. The INX 660 microscope produces automated analysis results that are accurate and repeatable. Accuracy ensures that even the smallest defects are detected and used to assess the condition of the connector end-face, minimizing the occurrence of false passes and dirty fibers being placed into service. Repeatability, obtaining the same result test after test, provides confidence in the inspection test results.

Results You Can Trust ... Always

Achieve Faster Workflow with True Automated Operation

The INX 660 automates every step of the inspection process to deliver fast, reliable, and repeatable results. Users simply attach the appropriate tip and inspect. The microscope automates setup, image focus, image capture, image analysis, and results storage.



Fully Automated with INX 660

SETUP → FOCUS → CAPTURE → ANALYZE → SAVE

With complete cycle times under 5 seconds for single fiber connectors, combined with the industry's fastest tip changing process, the fully automated capability of the INX 660 equips technicians with the fastest workflow in fiber connector inspection.

AutoID Inspection Tips Ensure Hassle-Free Simplicity

INX 660 utilizes FPT inspection tips. Designed for use in field environments, each rugged stainless-steel tip integrates AutoID technology that auto-configures the microscope for the connector under inspection, eliminating additional actions and potential mistakes that occur with manual or RFID configuration methods.

- Easily switch between connector types
- Optical settings configured automatically
- Most recent analysis profile applied automatically
- Rugged stainless-steel construction
- Single piece design
- Fast-threading coupling collar



See What Other Microscopes Can't

Fully Automated Simplex Connector Inspection

The INX 660 and INX 760 microscopes share the same simplex inspection tips. Simply mate the tip with the connector end-face to trigger True Automated Inspection.

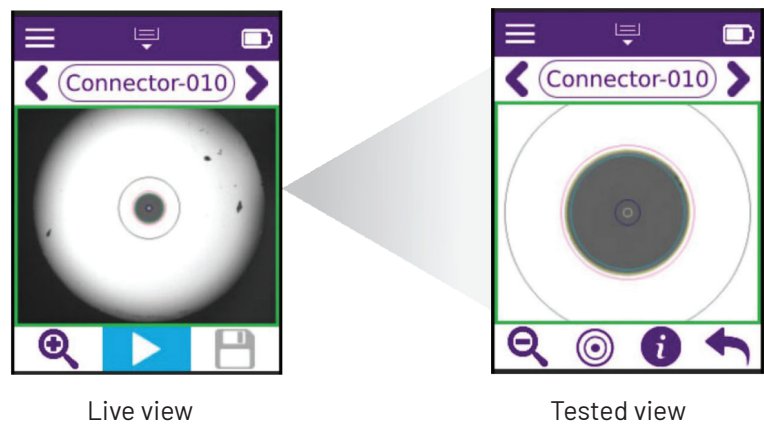

Semi-Automated Multifiber Connector Inspection

Prompted inspection of multifiber connectors with INX 660 semi-automated tips. Rotate the manual panning wheel to the indicated position and capture an image. The individual captures are automatically stitched together and pass/fail image analysis is performed for the entire connector.

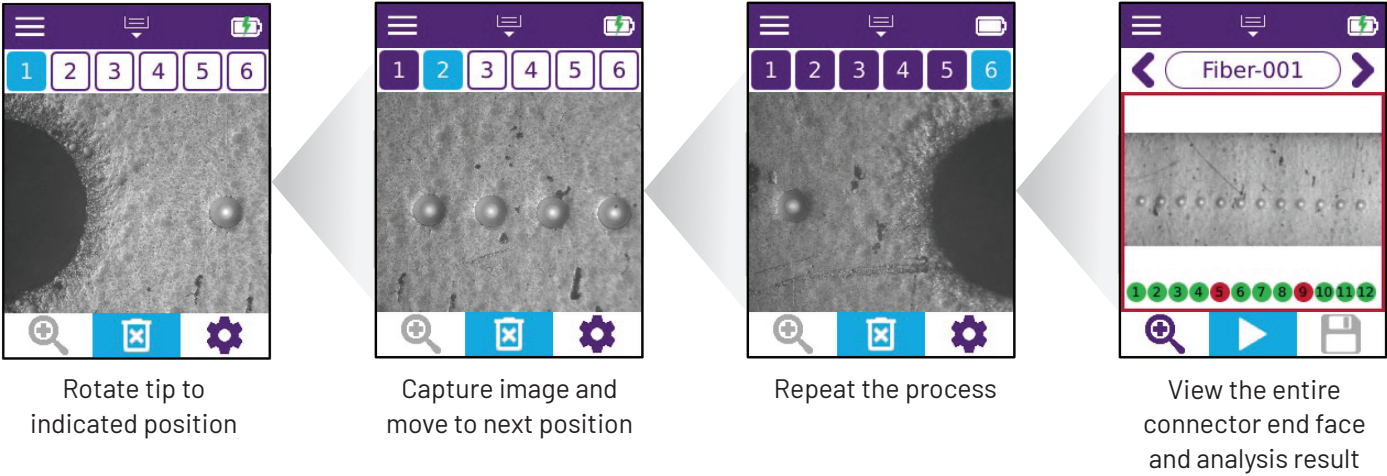

Key Features



Stay Connected with VIAVI TPA

INX 660 connects with the VIAVI TPA ecosystem to streamline field workflows, boost productivity, and increase visibility. This systematic, closed-loop workflow solution connects teams with their VIAVI test instruments to ensure repeatability, efficiency, and accuracy at every stage of a job.

VIAVI TPA™ Ecosystem Overview

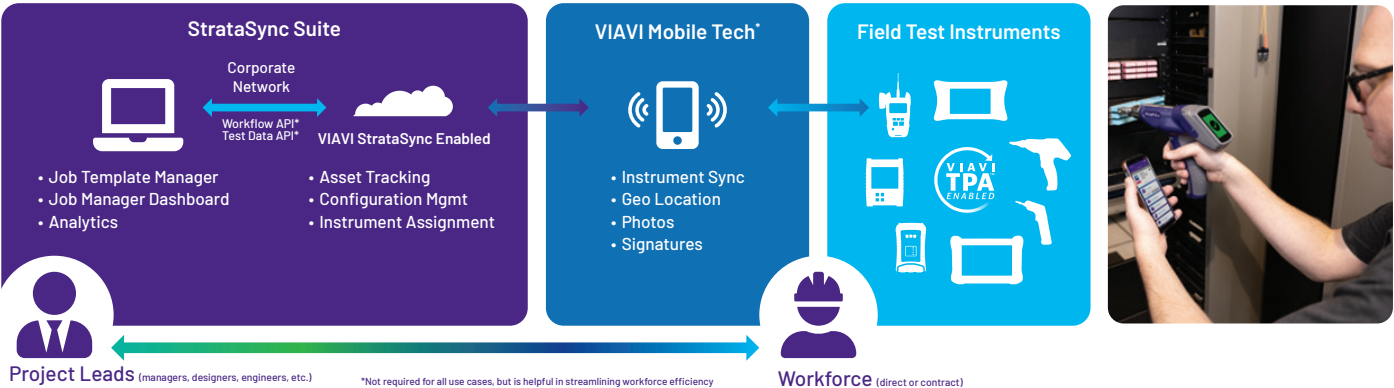

Specifications

| Parameters | Specification |
|----------------------------------|--|
| Field of view | Single fiber: 1000 x 1425 µm |
| | Multifiber: 4750 x 1425 µm |
| View modes | Live, Inspected |
| Magnification modes | Low, High (with auto center) |
| Focus | Auto (on insert, on trigger) |
| Image analysis | Auto (IEC 61300-3-35 edition 2 or 3, user defined) |
| Auto focus + image analysis time | ≤ 4 s (single fiber) |
| Results | Save action: manual, auto (if pass, if fail, always) |
| | Save time: ≤ 1 s (single fiber) |
| | Storage: ≤ 10,000 single fiber, ≤ 1,500 multifiber, or proportional distribution |
| Hard buttons | Power, Trigger |
| Display | 320 x 240-pixel (2.4 in) color backlit touch screen |
| Status indicators | LED ring, power/battery charging LED, speaker |
| Power supply | 5V/2.1A USB AC adapter |
| Battery | Li-ion (field serviceable) |
| Wired connectivity | USB-C port with optional locking mount |
| Wireless connectivity | Bluetooth® 5.2 BLE, WiFi 802.11b/g/n |
| Operation temperature | 0°C to 40°C (32°F to 104°F) |
| Operation humidity | 0 to 90% non-condensing |
| Storage temperature | -20°C to 60°C (-4°F to 140°F) |
| Dimensions (L x H x W) | 253 x 191 x 60 mm (9.9 x 7.5 x 2.4 in) without a tip |
| | 275 x 191 x 60 mm (10.8 x 7.5 x 2.4 in) with an LC tip |
| Weight | 0.4 kg (0.9 lb.) without a tip |
| Inspection tips | Simplex |
| | Semi-auto multifiber (rows ≤ 2, fibers/row ≤ 16) |
| | Integrated AutoID technology |
| | Stainless steel with threaded mounting nut and tether point |
| VIAVI TPA compatibility | VIAVI Mobile Tech 5.6 or later, StrataSync 17.0 or later |
| PC reporting software | ReportPRO™ |

Ordering Information

Kits

| Part Number | Description |
|--------------|---|
| INX-660-KIT1 | INX 660 Microscope: Automated Simplex Inspection, BT WiFi Connectivity |
| | Tips: Bulkhead tips for LC/PC, SC/PC |
| | Mating adapters: LC duplex, SC duplex |
| | Accessories: Tip cover, tip storage case, USB charging adapter and cable, carrying case |
| INX-660-KIT2 | INX 660 Microscope: Automated Simplex Inspection, BT WiFi Connectivity |
| | Tips: Bulkhead tips for LC/PC, LC/APC, SC/PC, SC/APC |
| | Mating adapters: LC duplex, SC duplex |
| | Accessories: Tip cover, tip storage case, USB charging adapter and cable, carrying case |
| INX-660-KIT3 | INX 660 Microscope: Automated Simplex Inspection, BT WiFi Connectivity |
| | Tips: Bulkhead tips for MPO/APC, LC/PC, SC/PC |
| | Mating adapters: MPO, LC duplex, SC duplex |
| | Accessories: Tip cover, tip storage case, USB charging adapter and cable, carrying case |

Tips

The INX 660 supports FPT simplex and semi-automated multifiber tips. Duplex and fully automated multifiber tips are not supported. Refer to the selection guide for Fiber Inspection Tips And Adapters viavisolutions.com/tipguide

Accessories

| Part Number | Description |
|------------------|---|
| FPT-MPO-COUPLER | MPO Bulkhead Mating Adapter for INX |
| ZP-HW-00457 | SC Duplex Bulkhead Mating Adapter |
| ZP-HW-00458 | LC Duplex Bulkhead Mating Adapter |
| FPP-INX7-HOLSTER | Holster for INX 660 and 760 microscopes |
| FPP-INX6-TIPC | Tip Cover for INX 660 and 760 microscopes |
| FPP-INX7-TIPC | Tip Cover for INX 660 and 760 microscopes |
| FPP-INX-TCASE1 | Tip Case |
| FPP-INX7-BATTERY | Rechargeable Battery for INX 660 and 760 microscopes |
| FCPP-PS1 | USB Output AC Input Charger with US EU UK AU Adapters |
| FBPP-DPAC9 | Type C USB Male to Type A USB Male Cable |
| FCLP-LAN-10 | Tip Lanyard 10 cm |

VIAVI Care Support Plans

Increase your productivity for up to 5 years with optional VIAVI Care Support Plans:

- Maximize your time with on-demand training, priority technical application support and rapid service.
- Maintain your equipment for peak performance at a low, predictable cost.

Plan availability depends on product and region. Not all plans are available for each product or in every region. To find out which VIAVI Care Support Plan options are available for this product in your region, contact your local representative or visit: viasolutions.com/viavicareplan

Features

*5-year plans only

| Plan | Objective | Technical Assistance | Factory Repair | Priority Service | Self-paced Training | 5 Year Battery and Bag Coverage | Factory Calibration | Accessory Coverage | Express Loaner |
|---|------------------------------------|----------------------|----------------|------------------|---------------------|---------------------------------|---------------------|--------------------|----------------|
|  BronzeCare | Technician Efficiency | Premium | ✓ | ✓ | ✓ | | | | |
|  SilverCare | Maintenance & Measurement Accuracy | Premium | ✓ | ✓ | ✓ | ✓* | ✓ | | |
|  MaxCare | High Availability | Premium | ✓ | ✓ | ✓ | ✓* | ✓ | ✓ | ✓ |

